

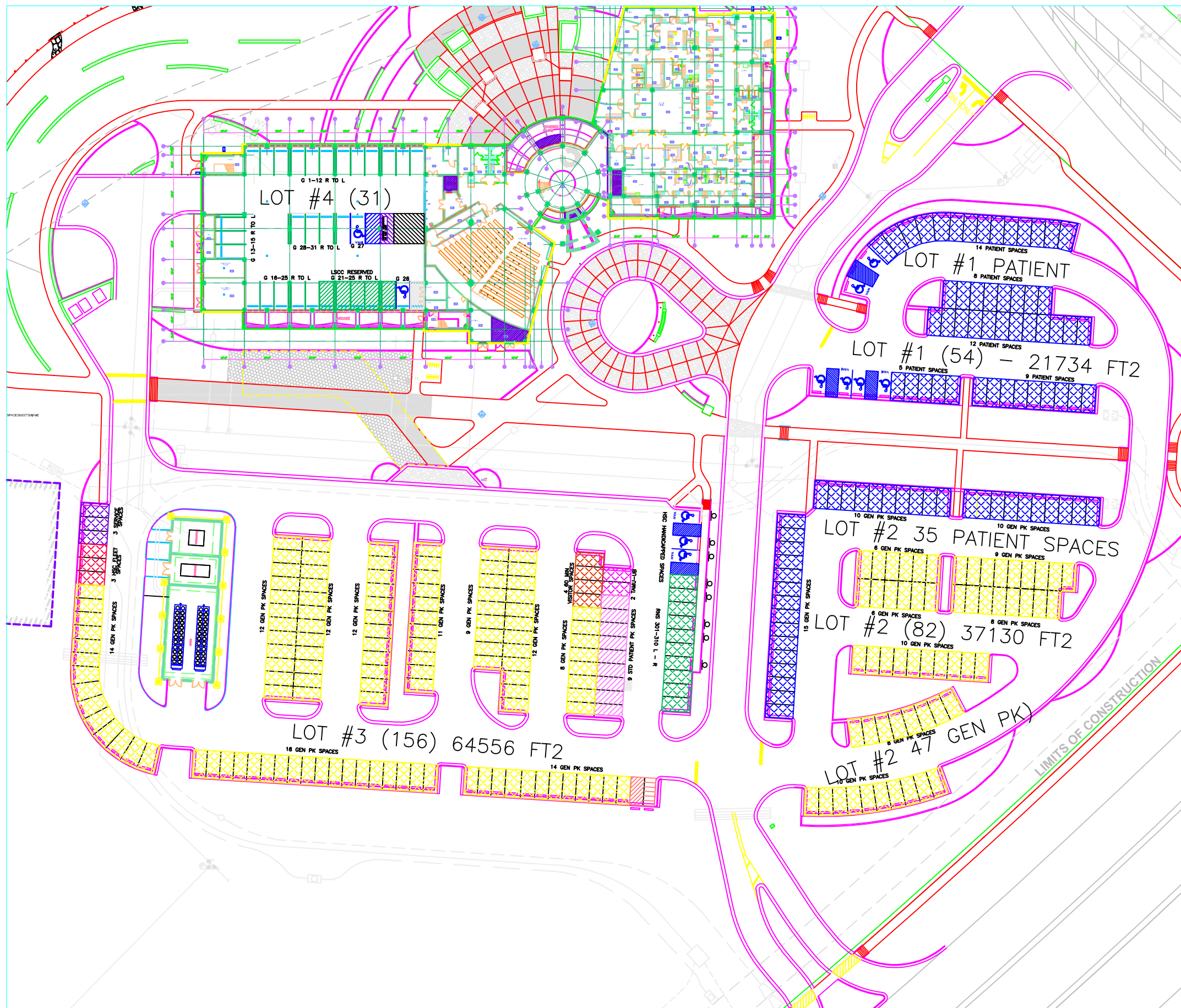

TEXAS A&M-HEALTH SCIENCE CENTER
 CAMPUS OPERATIONS
 8441 RIVERSIDE PKWY
 SUITE 4400
 BRYAN, TEXAS 77807

LEGEND

- HANDICAPPED
- 24 HOUR RESERVED
- CLINICIAN PARKING
- PATIENT PARKING
- VISITORS - 60 MINUTE LIMIT
- HSC FLEET VEHICLES
- SERVICE PARKING
- MOTORCYCLE PARKING
- GENERAL PARKING
- TAMU + UB



PROJECT NAME _____

TEXAS A&M-HEALTH SCIENCE CENTER
 3950 A.W. GRIMES ROAD
 ROUND ROCK TEXAS 78665

PROJECT NUMBER _____

ISSUE _____

DATE
 08/07/19

SCALE
 1" = 70'

DRAWING TITLE _____

DRAWING NUMBER _____

1 ROUND ROCK PARKING PLAN
 SCALE: 1" = 70'